

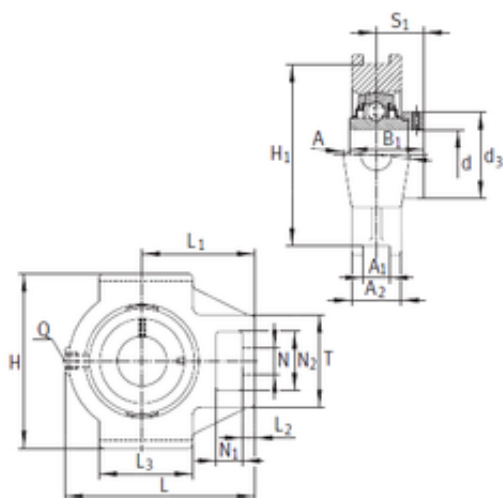

# Koyo NRB BEARING MANUFACTURING LLC

## INA RTUE30 Take-Up Ball Bearing

Bearing No. RTUE30



RTUE30 Bearing 2D drawings and 3D CAD models

Bore Diameter	30 mm
d	30 mm
S1	30,2 mm
Thread (Q)	Rp1/8
L2	10 mm
L3	57 mm
d3	44 mm
A	37 mm
A1	12 mm
B1	48,5 mm
H	102 mm
H1	89 mm
L	114,5 mm
L1	70 mm
N	22 mm
N1	18 mm
T	56 mm
A2	25 mm
N2	36,5 mm
Weight	1,24 Kg
Basic dynamic load rating (C)	19,5 kN
Category	Take Up Unit Bearings
Inventory	0.0
Manufacturer Name	SCHAEFFLER GROUP
Minimum Buy Quantity	N/A
Weight / Kilogram	1.24



## Koyo NRB BEARING MANUFACTURING LLC

Product Group	M06110
Component Description	Take Up Bearing Only
Rolling Element	Ball Bearing
Housing Style	Unit Only
Mounting Method	Eccentric Collar
Compatible Take Up Frame	Not Specified
Adjustment Travel Length	0
Insert Part Number	GE30KRRB
Housing Material	Cast Iron
Other Features	Single Row   Spherical   Double Land Riding Rubber Contact Seal
Inch - Metric	Metric
Long Description	Take Up Bearing Only; 30MM Bore; 12MM Slot Width; 89MM Slot to Slot Distance; Ball Bearing; Unit Only; Eccentric Collar Mount; GE30KRRB Insert Part; Cast Iron Housing Material
Category	Take Up Units
UNSPSC	31171533
Harmonized Tariff Code	8483.20.40.40
Noun	Bearing
Keyword String	Take Up
Manufacturer URL	<a href="http://www.ina.com">http://www.ina.com</a>
Weight / LBS	2.734
Slot to Slot Distance	3.504 Inch   89 Millimeter
Slot Width	0.472 Inch   12 Millimeter
Bore	1.181 Inch   30 Millimeter