

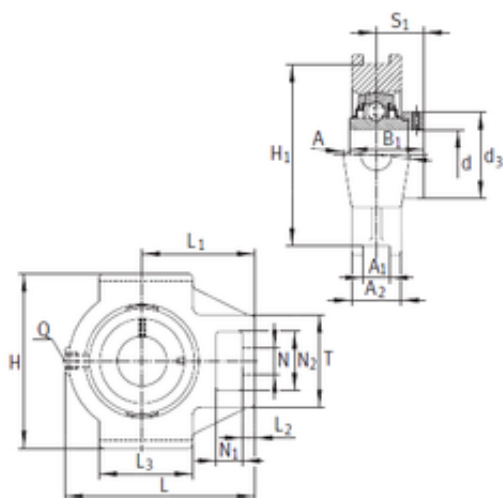

Koyo NRB BEARING MANUFACTURING LLC

INA RTUE50 Take-Up Ball Bearing

Bearing No. RTUE50



RTUE50 Bearing 2D drawings and 3D CAD models

Bore Diameter	50 mm
d	50 mm
S1	38,2 mm
Thread (Q)	Rp1/8
L2	16 mm
L3	85 mm
d3	69 mm
A	50 mm
A1	16 mm
B1	62,8 mm
H	115 mm
H1	102 mm
L	148 mm
L1	90 mm
N	29 mm
N1	20 mm
T	83 mm
A2	35 mm
N2	49 mm
Weight	2,57 Kg
Basic dynamic load rating (C)	35 kN
Category	Take Up Unit Bearings
Inventory	0.0
Manufacturer Name	SCHAEFFLER GROUP
Minimum Buy Quantity	N/A
Weight / Kilogram	2.65



Koyo NRB BEARING MANUFACTURING LLC

Product Group	M06110
Component Description	Take Up Bearing Only
Rolling Element	Ball Bearing
Housing Style	Unit Only
Mounting Method	Eccentric Collar
Compatible Take Up Frame	Not Specified
Adjustment Travel Length	0
Insert Part Number	GE50KRRB
Housing Material	Cast Iron
Other Features	Single Row Spherical Double Land Riding Rubber Contact Seal
Inch - Metric	Metric
Long Description	Take Up Bearing Only; 50MM Bore; 16MM Slot Width; 102MM Slot to Slot Distance; Ball Bearing; Unit Only; Eccentric Collar Mount; GE50KRRB Insert Part; Cast Iron Housing Material
Category	Take Up Units
UNSPSC	31171533
Harmonized Tariff Code	8483.20.40.40
Noun	Bearing
Keyword String	Take Up
Manufacturer URL	http://www.ina.com
Weight / LBS	5.843
Slot to Slot Distance	4.016 Inch 102 Millimeter
Bore	1.969 Inch 50 Millimeter
Slot Width	0.63 Inch 16 Millimeter